

6868 White LED

Part No:

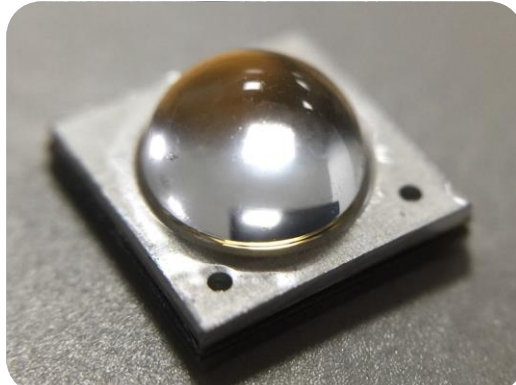

Features:

- Super High power 16W LED
- Patent LED
- 60D: 6.8*6.8*3.7mm
- 120D: 6.8*6.8*1.1mm
- ALN substrate with Quartz Lens
- ODM for automotive

■ Maximum Rating (Ta : 25°C)

Characteristics	Symbol	Min.	Typical	Max.	Unit
DC Forward Current ¹	I _F			350	mA
Pulse Forward Current ²	I _{PF}			1000	mA
Forward Voltage	V _F	12		16	V
Reverse Voltage	V _R		-10		V
Leakage Current (5V)	UV			10	μA
Junction Temperature ³	T _j		150		°C
Storage Temperature Range	T _{stg}	-40	–	100	°C
Soldering Temperature	T _{sol}		260		°C
Thermal Resistance Junction / Solder Point	R _{th}		0.2		°C/W
Viewing Angle	2θ _{1/2}		60/120		Deg
Electrostatic Discharge (HBM)	ESD		2		KV
Operating Temperature Range	Topr	-40°C		+85°C	°C
Color Rendering Index	CRI		70		

Notes:

1. For other ambient, limited setting of current will depend on de-rating curves.
2. D=0.01s duty 1/10.
3. When drive on maximum current , T_j must be kept below 150°C.
4. Viewing angle (2θ_{1/2}) ± 10°.

■ Voltage Binning

Item	Forward Voltage @350mA		
	Bin	Min	Max
Voltage	V1	12.0	16.0

■ Performance Group - Chromaticity

Bin	Cie-X	Cie-Y	Bin	Cie-X	Cie-Y
2700K (2500~2800)	0.4813	0.4319	3000K (2800~3200)	0.4562	0.4260
	0.4562	0.4260		0.4299	0.4165
	0.4373	0.3893		0.4147	0.3814
	0.4593	0.3944		0.4373	0.3893
	0.4813	0.4319		0.4562	0.4260

■ Performance Group – Brightness

Bin	L20	L25
Flux(lm)	200-250	250-300

Note:

1. Binning current @350mA
2. Tolerance is 10% unless other specified.

■ Outline Dimensions & Circuit

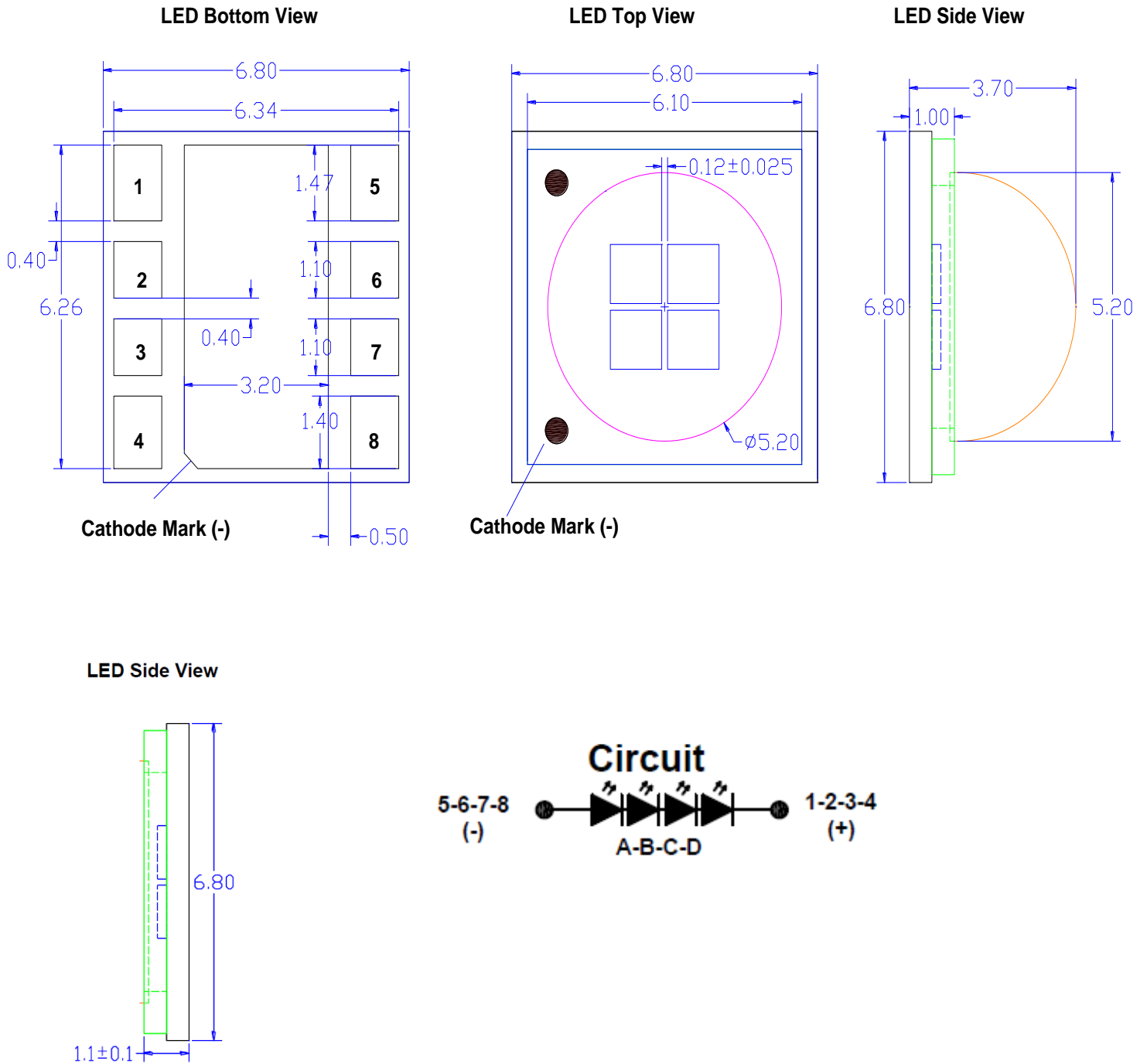

Notes:

1. All dimensions are in millimeters.
2. Tolerance is $\pm 0.025\text{mm}$ unless other specified
3. The dimension will be causing magnification by quartz lens

■ Suggest Stencil Pattern (Recommendations for reference)

**RECOMMENDED STENCIL PATTERN
(HATCHED AREA IS OPENING)**

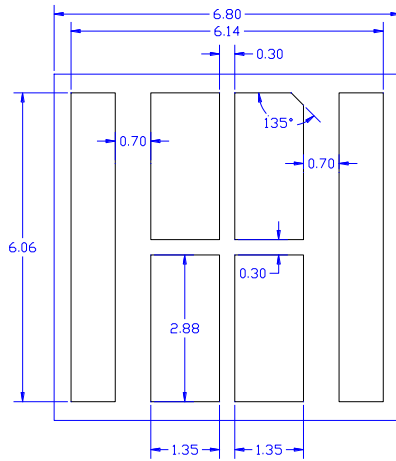

RECOMMENDED PCB SOLDER PAD

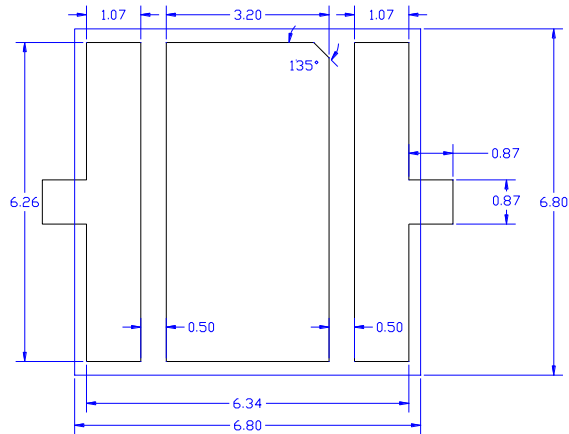

Notes:

1. Suggest stencil $t=0.12$ mm
2. All dimensions are in millimeters.
3. Tolerance is ± 0.13 mm unless other specified.

■ Packing

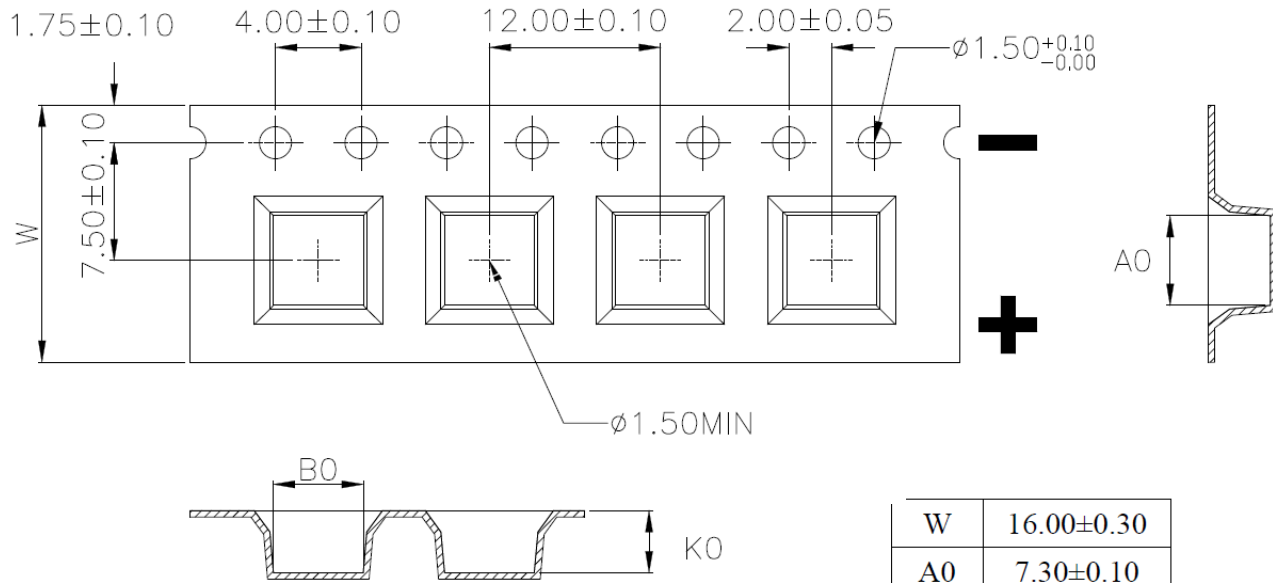

1. 10 sprocket hole pitch cumulative tolerance ± 0.20 .
2. Carrier camber is within 1 mm in 250 mm.
3. Material : Black Conductive Polystyrene Alloy.
4. All dimensions meet EIA-481-D requirements.
5. Thickness : 0.30 ± 0.05 mm.
6. Packing length per 22 " reel : 45.5Meters(1:3), 22" reel : 240.0Meters(1:16) W=105.
7. Component load per 13" reel : minimum 100 pcs and maximum 350 pcs

W	16.00±0.30
A0	7.30±0.10
B0	7.30±0.10
K0	4.30±0.10

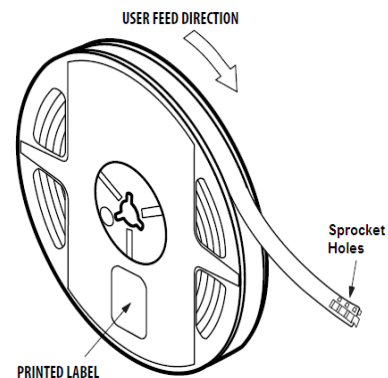
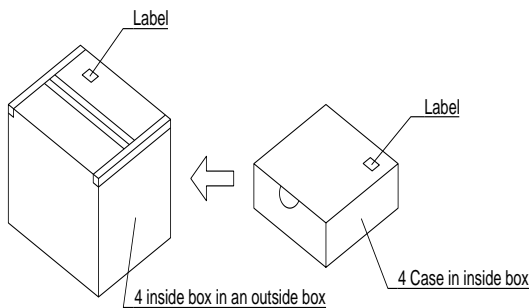

Notes:

1. Each Reel (minimum 100 pcs and maximum 350 pcs) is packed in a moisture-proof bag along with 2 packs of desiccant and a humidity indicator card;
2. A maximum of 5 moisture-proof bags are packed in an inner box (size: 240mm x 200mm x 105mm ± 5 mm).
3. A maximum of 4 inner boxes are put in an outer box (size: 410mm x 255mm x 230mm ± 5 mm).
4. Part No., Lot No., quantity should be indicated on the label of the moisture-proof bag and the cardboard box.